



PT EXIMA MAJU PERKASA
FULFILLING YOUR NEEDS

PRODUCT CATALOGUE

Industrial Electrical & Mechanical Spareparts Components,
Smelting Machineris and Enviromental Machines



Jl. Taman Galaxy Raya Block A-12,
Kelurahan Jakasetia, Kec.
Bekasi Selatan, Kota Bekasi



082114451779



PT EXIMA MAJU PERKASA

FULFILLING YOUR NEEDS



LuyangWool Blanket

Luyangwool blanket is high strength, needled insulating blanket that is made from wool bulk. The combination of long spun fibers and needling operation produce tough, resilient and strong blankets, which resist tearing both before and after heating. Luyangwool blanket is completely inorganic and available in a variety of temperature grades, densities, and sizes. Luyangwool blanket can be folded, compressed and encapsulated to produce modules.



Features

- Excellent thermal shock resistance
- Excellent thermal stability
- High tensile strength
- Low thermal conductivity
- Low heat storage

Typical Applications

- Pipe wrap
- Furnace and kiln back-up insulation
- Chimney insulation
- Annealing furnace linings
- Process heater linings

Typical Parameters

Description	LUYANGWOOL® STD BLANKET			LUYANGWOOL® HP BLANKET		LUYANGWOOL® HA BLANKET		LUYANGWOOL® HZ BLANKET	
Classification Temperature (℃)	1260			1260		1350		1430	
Chemical Composition (%)									
Al ₂ O ₃	≥43			≥44		≥52		≥35	
SiO ₂	≥54			≥55		≥47		≥49	
ZrO ₂	-			-		-		≥15	
Color	White			White		White		White	
Shot Content (%)	≤15			≤15		≤15		≤12	
Density (kg/m³)	64	96	128	96	128	96	128	96	128
Tensile Strength (kPa)	30	50	70	50	70	50	70	50	70
Permanent Linear Shrinkage (%)	1000℃ x24h≤2.5			1100℃ x24h≤2.5		1200℃ x24h≤3.0		1350℃ x24h≤3.0	
Thermal Conductivity (W/m·K)									
200℃	0.07	0.06	0.06	0.06	0.06	0.06	0.06	0.06	0.06
400℃	0.12	0.11	0.10	0.11	0.10	0.11	0.10	0.11	0.10
600℃	0.20	0.19	0.18	0.19	0.17	0.18	0.16	0.16	0.15
800℃	0.30	0.23	0.20	0.23	0.20	0.22	0.20	0.21	0.19
1000℃	0.40	0.32	0.27	0.31	0.26	0.30	0.26	0.30	0.26

Luyangwool Board

Luyangwool board is manufactured in a wet forming process using Luyangwool bulk and binders Luyangwool board is designed for insulation applications experiencing vibration, mechanical stress and erosive forces Luyangwool board can reduce energy costs and cycling times due to high insulating capability, as well as serving to protect refractory surfaces from thermal shock and chemical attack

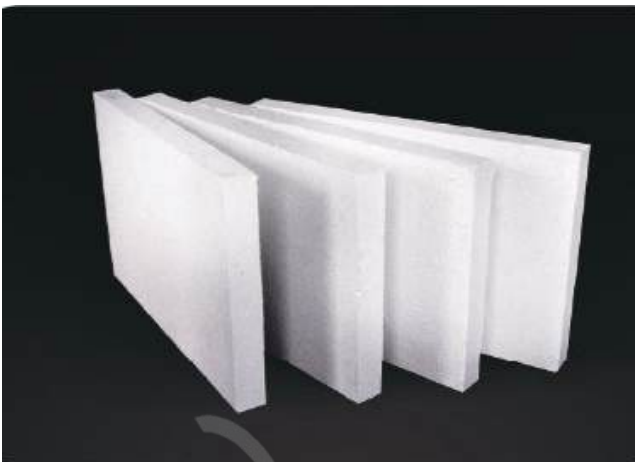

Features

- Excellent thermal shock resistance
- Can be machined, cut and shaped easily
- High rigidity and light weight
- Low thermal conductivity
- Low heat storage

Typical Applications

- Furnace hot face lining in petrochemical furnace
- Furnace hot face lining in ceramic kiln
- Board over blanket hot face lining
- Back-up insulation to brick & castable
- Expansion joints

Typical Parameters

Description	LUYANGWOOL® STD BOARD	LUYANGWOOL® HP BOARD	LUYANGWOOL® HA BOARD	LUYANGWOOL® HZ BOARD
Classification Temperature (℃)	1260	1260	1350	1430
Color	White	White	White	White
Density (kg/m³)	250/300/360	250/300/360	300/360	300/360
Modules of Rupture (MPa)	≥0.3	≥0.3	≥0.3	≥0.3
Compressive Strength (MPa,10% relative deformation)	0.15/0.25/0.3	0.25/0.3	0.25/0.3	0.25/0.3
Loss of Ignition (%)	≤6	≤6	≤6	≤6
Permanent Linear Shrinkage (%)	1000℃ x24h≤3.0	1100℃ x24h≤3.0	1200℃ x24h≤3.5	1350℃ x24h≤3.5
Thermal Conductivity (W/m·K)				
400℃	0.08	0.07	0.07	0.07
600℃	0.11	0.10	0.10	0.09
800℃	0.14	0.14	0.13	0.13
1000℃	0.19	0.19	0.19	0.18

Luyangwool Paper

Luyangwool® paper is manufactured by blending Luyangwool® bulk, binders, and additives. The specialized paper-making process is used to form uniform and flexible paper. Luyangwool® paper is easy to be handled and cut. Luyangwool® paper can be used in a wide range of applications as thermal insulation. It is especially suited to used in gaskets and as a parting medium.



Features

- Excellent thermal shock resistance
- Can be machined, cut and shaped easily
- High flexibility
- Low thermal conductivity
- Good dielectric strength

Typical Applications

- Gaskets for high temperature applications
- Gaskets for domestic appliances
- Back-up lining for metal troughs
- Thermal barriers for vehicles
- Expansion joints

Typical Parameters

Description	LUYANGWOOL® STD PAPER	LUYANGWOOL® HD PAPER	LUYANGWOOL® HZ PAPER
Classification Temperature (°C)	1260	1350	1430
Chemical Composition (%)			
Al ₂ O ₃	42-47	44-50	35-40
SiO ₂	52-57	49-55	45-48
ZrO ₂	-	-	13-16
Color	White	White	White
Density (kg/m³)	200	240	200
Tensile Strength (MPa)	0.4	0.7	0.4
Loss of Ignition (%)	≤10	≤6	≤10
Thermal Conductivity (W/m·K)			
200°C	0.06	0.06	0.06
400°C	0.09	0.08	0.08
600°C	0.13	0.13	0.12
800°C	0.20	0.19	0.19
1000°C	-	0.29	0.28
1200°C	-	0.43	0.42

Luyangwool Basalt Rock Wool Board

LUYANG BASALT rock wool board for industry has a certain strength, the fiber structure of which makes itself have the properties of good dimensional stability, thermal stability and chemical stability, and also have another three characteristics of excellent heat resistance, corrosion resistance and low thermal conductivity.

The rock wool board for industry is specially used for the equipments of boiler, kiln and distillation tower in the field of petrochemical industry, power plant and industrial manufacture. Products must be stored indoor, when placed outdoor, covering with waterproofing cloth is required

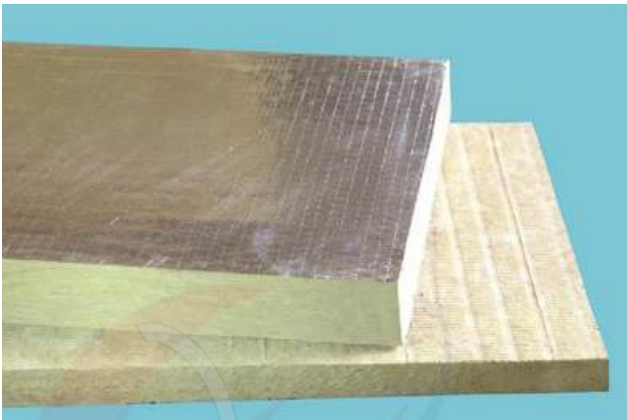

● 标准规格 Standard Size

产品名称 Product Name	鲁阳巴萨特工业板				
标称密度 Density(kg/m³)	60	80	100	120	180
厚度 Thickness(mm)	30-150				
尺寸 Size(mm)	1200x600				

● 技术参数 Technical Parameters

性能 Properties	单位 Unit	密度 Density(kg/m³)					测试标准 Standards
		60	80	100	120	180	
导热系数 (平均温度 25℃) Thermal conductivity(average 25℃)	W/(m.k)	≤0.040	≤0.038	≤0.038	≤0.038	≤0.038	GB/T10295 ASTM C177
燃烧性能 Combustion performance	--	不燃，防火等级A1级 Class-A1 non-combustible					GB8624 EN13501-1
憎水率 Hydrophobic rate	%	≥99	≥99	≥99	≥99	≥99	GB/T10299
最高使用温度 The maximun temperature	℃	550	650	750	750	750	GB/T17430 ASTM C411
推荐使用温度 Recommend service temperature	℃	450	550	650	650	650	GB50264 ASTM C411
热荷重收缩温度 Thermal shrinkage temperature under load	℃	500	650	650	650	650	GB/T11835
线收缩率 Linear shrinkage ratio	%	≤2	≤2	≤2	≤2	≤2	ASTM C356
腐蚀性 Corrosiveness	--	不腐蚀 No corrosion					ASTM C665

Luyangwool Basalt Rock Wool Blanket

LUYANG BASALT rock wool blanket for industrial insulation, is a kind of rock wool product like roll felt, with the sturdy resilient felt and galvanized iron wire netting or stainless steel wire netting being sewed up with galvanized iron wire or stainless steel wire, and the retentivity of this structure makes rock wool felt not break, and have good flexibility, thermal insulation performance,convenience for construction.

Mainly used in thermal insulation, fire prevention and sound absorption of large aperture pipeline, large storage tank, container, boiler and blast pipe in the field of petrochemical industry, power plant and so on. Product can also be used in the place with high temperature, vibration and high fireproof requirements.



● 标准规格 Standard Size

产品名称 Product Name	鲁阳巴特工业保温岩棉毡							
标称密度 Density(kg/m³)	60			80			100	
宽度 Width (mm)	600, 900							
厚度Thickness (mm)	50	60	70	50	60	70	40	50
长度 Length (mm)	5000	4000	3000	5000	4000	3000	5000	5000

● 技术参数 Technical Parameters

性能 Properties	单位 Unit	密度 Density(kg/m³)			测试标准 Standards
		60	80	100	
导热系数 (平均温度 70℃) Thermal conductivity(average 70℃)	W/(m.k)	≤0.040	0.038	0.038	GB/T10295 ASTM C177
燃烧性能 Combustion performance	--	不燃，防火等级A1级 Class-A1 non-combustible			GB8624 EN13501-1
憎水率 Hydrophobic rate	%	≥99	≥99	≥99	GB/T10299
最高使用温度 The maximun temperature	℃	550	750	750	GB/T17430 ASTM C411
推荐使用温度 Recommend service temperature	℃	450	650	650	GB50264 ASTM C411
热荷重收缩温度 Thermal shrinkage temperature under load	℃	400	400	400	GB/T11835
线收缩率 Linear shrinkage ratio	%	≤2	≤2	≤2	ASTM C356
腐蚀性 Corrosiveness	--	不腐蚀 No corrosion			ASTM C665

Luyangwool Basalt fireproofing black rock wool board

LUYANG BASALT fireproofing black rock wool board, as a kind of black brown rock wool board,is specially designed for curtain buildings with high request for fireproofing grade. The product has the properties of high melting points. long fire-resistant limit* resistance to high temperature shrinkage. no corrosion to metal parts and so on, besides ones of common rock wool boards.

LUYANG BASALT fireproofing black rock wool board is filled into the gap between curtain wall and floor slab or partition wall, for fireproofing and cutting off the spread of smoke and gas, and fire blocking in the building gaps including around pipes through the floor slab or wall, can also be used for fire protection separation of the wall between windows in the curtain-wall-system buildings. Besides, the product can also be used as filler of fireproof doors and fire roll shutters in order to enhance the fire



● 标准规格 Standard Size

产品名称 Product Name	鲁阳巴萨特工业保温岩棉缝毡							
标称密度 Density(kg/m³)	60		80			100		
宽度 Width (mm)	600, 900							
厚度Thickness (mm)	50	60	70	50	60	70	40	50
长度 Length (mm)	5000	4000	3000	5000	4000	3000	5000	5000

● 技术参数 Technical Parameters

性能 Properties	单位 Unit	密度 Density(kg/m³)			测试标准 Standards
		60	80	100	
导热系数 (平均温度 70℃) Thermal conductivity(average 70℃)	W/(m.k)	≤0.040	0.038	0.038	GB/T10295 ASTM C177
燃烧性能 Combustion performance	--	不燃，防火等级A1级 Class-A1 non-combustible			GB8624 EN13501-1
憎水率 Hydrophobic rate	%	≥99	≥99	≥99	GB/T10299
最高使用温度 The maximun temperature	℃	550	750	750	GB/T17430 ASTM C411
推荐使用温度 Recommend service temperature	℃	450	650	650	GB50264 ASTM C411
热荷重收缩温度 Thermal shrinkage temperature under load	℃	400	400	400	GB/T11835
线收缩率 Linear shrinkage ratio	%	≤2	≤2	≤2	ASTM C356
腐蚀性 Corrosiveness	--	不腐蚀 No corrosion			ASTM C665

Reverberatory



Typical Parameters

Description of combustion & control system	Alarm prompt function equipped
Heat storage body size: designed as required	Alarm function
Heat storage weight: about 4700kg	Heat storage box over temperature alarm
Burner power: 2 million calories	Fault indication of four-way reversing valve
Melting rate: designed as required	Pneumatic butterfly valve fault indication
Combustion medium: natural gas, lpg, diesel etc.	Small gun flame extinguishing function
Alumina specifications: greenwich 25mm-30mm	Big gun flamme extinguishing prompt function
Alumina weight: 1000kg	Cooling fan overload indication
Flame detection: ionization type	Combustion fan overload indication
Ignition mode: aitomatic ignition	Exhaust fan overload indication
Burning time can be set and modified	Fumace door motor overload prompt function
Switching mode: atomatic switching	Compressed air pressure low prompt function
Heat storage temperature: greater than 800oC	Cooling air pressure low prompt function
Exhaust temperature: less than 150oC	Gas pressure low prompt function
PLC controller: siemens, Germany, Touch screen display	Fumace pressure too high prompt function
Appliance Siemens and Schneider,Mitsubishi	Door control: motor control, chain + auxiliary steel wire rope

Plant Layout

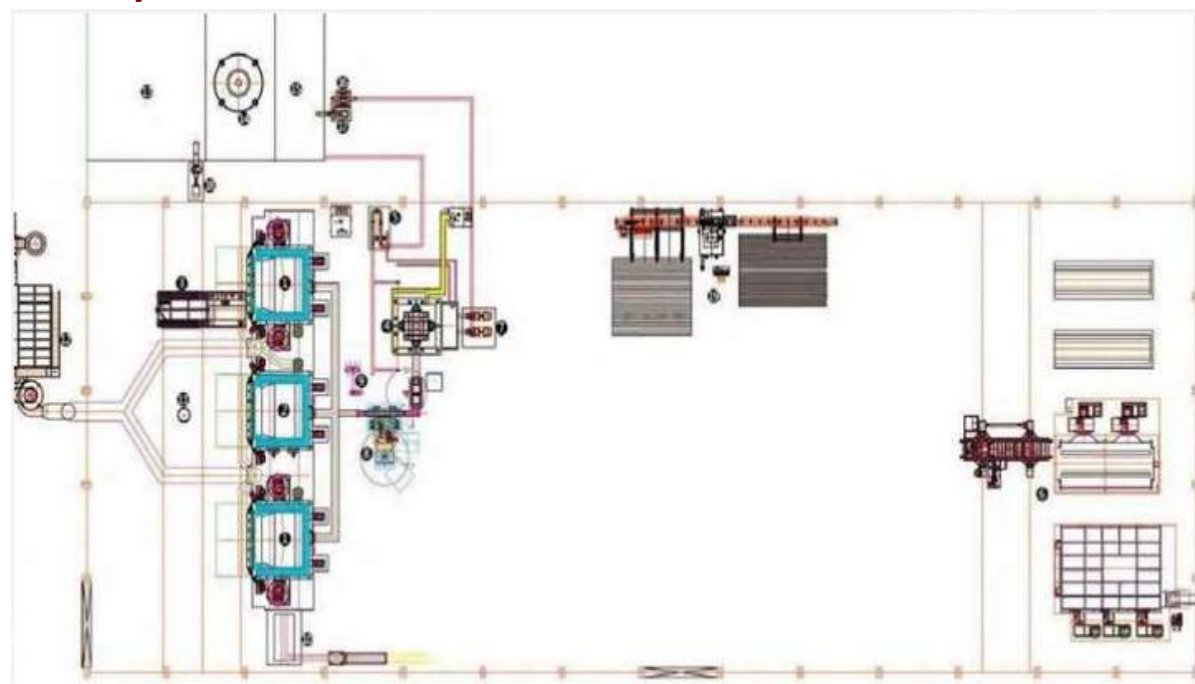

Rotary Furnace

Rotary equipment applied in mass processing aluminum slag (cold and hot slag), and can save human resources fully, and guarantee the good, the recovery rate of metal aluminum, aluminum slag iron kind of matter will not affect the metal recovery of aluminum iron content, and can be repeated after treatment by cold ash bucket filter the coarse particle of cold slag, to ensure maximum recovery



Main Parameters

- Capacity: 3T - 8T The barrel rotation speed is 1.5--2 r/ min
- Attendant operation (handling hot slag) : 2-4 hours / furnace
- Treatment of cold slag : 3-5 hours / furnace
- Recovery rate $\geq 85\%$

Dust Collector



SPECIFICATION

- Leading design , reasonable structure , beautiful appearance , safe and explosion - proof
- 100 % off - line ash cleaning in room to ensure thorough ash cleaning
- Automatic temperature control to avoid filter bag paste bag.
- Man - machine interface , intelligent control , simple operation , remote monitoring
- Automatic air volume control, environmental protection and energy saving / particle emission less than $10\text{mg} / \text{nm}^3$
- The main electrical control cabinet of n dust collector is arranged nearby in the accessories of dust collector, including PLC pulse ash cleaning control cabinet and main motor frequency conversion control cabinet. all electrical components adopt Zhengtai, Omron and other high - quality products to ensure the stability of the equipment .
- The main motor adopts frequency conversion control, which can automatically adjust the current (rotational speed) of the main motor according to the required air volume , so as to meet the specified air volume requirements on the basis of energy saving.

Aluminium Ingot Casting Machine



The ingot casting machine uses linear type which is more maturity during recent years. The power - driven part uses variable frequency control driver to motor speed so that it is stable running, and reduces the shaking of the equipment. The meter shows the ingots amount in every minute, intuitive and simple. Demould uses pneumatic beating so that its effect is better. Ingot casting has a high efficiency, average weight, high automation , low labor strength, easy operation, convenient maintenance and other advantages. The whole system is safety and reliable, low operating cost, less pollution to environment, Easy operation.

Wire Rope Winch System



Winch system-casting machine adopts frequency control. it can move inghing up/ down or automatically digital display the speed casting lenght cooling water temperature and aluminum liquid temperature as well as audible alarm before reaching the end of casting and safety stop before empty car coming up to the position during the un-casting process, the machine can achieve the function of quick up and quick down and switch slow & fast at the high position or low position.

Specification

Quantity : customized Casting speed 30-250mm / min (stepless speedregulation)

Casting speed accuracy + 1 %

Casting length control accuracy (setpoint) < + 5 %

Billetbending < 10mm / theen tire ingot length

ASH Treatment Machines



Performance Introduction :

(suitable for manufacturers with slag production within 300kg to 1000Kg per furnace. This product adopts mobile slag pot to receive hot slags in front of the furnace and send the hot slags to the equipment for processing. All processes are completed in the sealed equipment. The fronter recycles morethan 80% aluminum water and the rear screens out recyclable aluminum blocks, aluminum particles and aluminum ash (the stacking temperature is about 70°C) which are directly imported into ton bags. old slag, to ensure maximum recovery

Cooling Drum and Dross Size Seperator



After going through ash fry machine, the dross is then transferred to the cooling drum for crushing and lowering the temperature of the ash before going through strainer for separation

Billet Castin Mould



Product Introduction

During the casting process, the liquid aluminum liquid is cooled to make it cast aluminum billet that meet the requirements. The circulating water system adopt hotdip galvanizing treatment and other important are treated with special anti corrosion paint for ships to ensure the service life of the casting system

Features:

- Hydraulic titing
- Galvanization process for cool water tank
- Forged crystallzer and high purity graphite ring
- Customized refractories
- Frame base for better strength

Round Billet :

- Diameter $\varnothing 63\text{mm}$ - $\varnothing 600\text{mm}$
- Billet length 6000 - 12500
- Batch quantity 2 - 144 (Depend on diameter)

Slab :

- Width 66 - 1300
- Thickness 66 - 460
- Lenght 6000-8000
- Bacth quantity 2 - 4 (Depend on size)



Degasser



Main Parameters :

- Purpose of use: aluminum liquid degassing.
- Gas flow: (8-20l / min).
- Equipment power: 380V 50HZ.
- Control method: inverter proportional control.
- Lifting power: 1.1KW 6. Rotor power: 0.75KW (speed 500 rpm).
- Cantilever length: 800MM.
- Graphite rotor: 200MM shaft length 750MM

Main Configuration :

- Variable frequency controller: 1 set Power: 1.1KW
- Elevating gear motor: 1 set Power: 1.1KW
- Rotary motor : 1 set Power: 0.75KW
- Contactor: 2 pcs Model: CJX2
- Air switch 1 set Model: EA53B 3P 20A
- Graphite rotor 1 set Model: 70 * 750 * 200

Structure OF Degasser :

The column is made of 180 * 180mm square tubes. The bottom frame is welded with 6 channel steel. The cantilever is welded with 10MMA3 steel. The A16 chain is used for lifting. The main column bottom frame is moved by hand wheels, graphite rotor, graphite scroll plate. Travel switch, air supply pipeline, compact structure, less space occupation.

FSM-A1



FSM-A1 System ensure steady flow of flux into the melting furnace removing residue from molten aluminum.

Benefits :

- Cart-like moving system ensuring agility
- Lightweight
- Better control flux output
- Timer sets and displays
- Maximized flux usage
- Lowering production cost, energy and consumption
- Reducing gas and residue content

Product Specifications

Measurement	Value
Tank Capacity - L	20L, 40L, 60L
Flow Rate (Kg/min)	0.5 - 3 Kg(customizable output)
Motor Power	0.45Kw, 200V
Weight - Kg	50 Kg
Dimensions	1000*1300*450mm
Flux Output System	Screw
Gas	Nitrogen/Argon
Gas Input Pressure	0.4 - 0.7 MPa

Metalurgic Sample Cutting



Technical Specifications :

- Motor power: 180w
- Throwing disc diameter: 200mm.
- Cooling system.
- Speed: 1400r/min or 900r/min (customized).
- Power supply: 380v, 50Hz or 220v, 50Hz (customized)
- Dimensions: 730x405x308mm.
- Main accessories: 2 pieces of polishing fabric.

Metalurgic Specimen Machine



Technical Specifications:

- Specimen pressing specification $\varnothing 22 \times 15 \text{mm}$; $\varnothing 30 \times 15 \text{mm}$;
- Heater specification 650W 220V
- Temperature adjustment range 100-180°C
- Control power supply voltage fluctuation is not more than $\pm 15\%$, 220V, 50Hz
- Dimensions 340X270X400mm 6. Net weight 33Kg

Metalurgic Sample Polishing Machine



Technical specifications:

- Specimen pressing specification $\varnothing 22 \times 15 \text{mm}$; $\varnothing 30 \times 15 \text{mm}$;
- Heater specification 650W 220V.
- Temperature adjustment range 100-180°C.
- Control power supply voltage fluctuation is not more than $\pm 15\%$, 220V, 50Hz.
- Dimensions 340X270X400mm.
- Net weight 33Kg

Spare Parts

Graphite Ring



Cone



Filter



Crytallizer



Distributor & Feeder



Spare Parts

Regenerative Burner



Transfer Ladle



Chain



Manifold



Ingot Mould



Felt Cloth



Roller Series

Roller-PK



Specifications:

- (PBO+Kevlar) 600°C PBO roller
- Super high temp. Resistance roller
- Suitable for use before fly cut, effectively improve the scratch mark made by the graphite

Roller-K



Specifications:

- 500°C kevlar roller
- High temp. Resistance roller
- Suitable for use after fly cut and run out table.

Roller Series

Roller-NNP



Specifications:

- 280°C Nomex roller
- Moderate temp. roller
- Only suitable for use of finished saw table and room temperature roller

Roller-PE



Specifications:

- 180°C PE roller
- Low temp. roller
- Only suitable for use of finished saw table and room temperature roller

Each high temp. resistance roller has its own counterfeited trademark, which effectively avoids other small factory to copy our products, ensures our customers get the original authentic products and protects customer rights as well as to guarantee the quality of the felt belt you have purchased, therefore ensure the stable transferring of your aluminium equipment and high-quality production

Type 型号	Color 颜色	Composition 组成
Roller-PK	Brown 褐色+黄色 600°C	mmPBO Outside+mm Kevlar PBO+Kevlar
Roller-K	Yellow 黄色 500°C	100%kevlar
Roller-NNP	Off White 米白色 280°C	Nomex+Polyester
Roller-PE	White 白色 180°C	100%Polyester

Available Size Inside Diameter

- Ø 41, 43, 44, 45
- Ø 49, 50, 51
- Ø 60, 61, 62, 63
- Ø 76, 77
- Ø 80, 81, 82
- Ø 90, 95
- Ø 100, 101, 102
- Ø 114, 115
- Ø 120, 127

Seamless Conveyor Belt

Seamless Conveyor Belt has been equipped with a security code - - the embedded "product anti-counterfeiting label", which effectively prevents other small manufacturers counterfeiting our products. Ensure that customers get the original products produced by our company. While protecting your consumption rights and interests, we can ensure that the belt you purchased is in good quality, so as to ensure that your aluminium materials and equipment can be transported steadily and produce better aluminium products.

Belt - PKN



Specifications:

- 600°C PBO seamless conveyor belt
- Super high temp. seamless belt
- Only suitable for run out table and cooling table (high Temp Zone)

Belt - KN



Specifications:

- 500°C kevlar seamless conveyor belt
- High temp . seamless belt
- Only suitable for run out table and cooling table (high Temp Zone)

Belt - NNP



Specifications:

- 280°C Nomex seamless conveyor belt
- Middle temp .seamless belt
- After stretching conveyor only (Middle Temp Zone)

Belt - PE



Specifications:

- 180°C polyester seamless conveyor belt
- Low temp. seamless belt
- Application for storage table, saw, table, loading & unloading line for anodizing and painting(Room Temp Zone)

Available Size

- Width : 20mm-1500mm
- Length : 1700mm-11000mm
- Thickness : 8, 10, 12 mm

Type 型号	Color 颜色	Composition 组成
Belt-PKN	Brown+Yellow 600°C	PBO+Kevlar+one layor Nomex tension member PBO+Kevlar+Nomex基布
Belt-KN	Yellow 500°C	Kevlar+one layor Nomex tension member Kevlar+Nomex基布
Belt-NNP	Off White 280°C	100%Nomex+one layor Nomex tension member 100%Nomex+Nomex基布
Belt-PE	White 180°C	100%polyester+one layor Nomex tension member 100%polyester+Nomex基布

Felt Pad Series



- Available size
- width 30mm-1500mm
 - Thickness 8 10 12mm
 - Hard type : Resin Treatment
 - Lengthch UP to 20000mm Treated with Resin

Type 型号	Color 颜色	Composition 组成	温度
Pad-PK	褐色加黄色 Brown+yellow	PBO+Kevlar基布	600℃
Pad-KK	黄色 Yellow	100%Kevlar100% Kevlar+Kevlar基布	500℃
Pad-NP	米白色 off white	Nomex+Kevlar	280℃
Pad-PE	白色 white	100%Kevlar100% Kevlar+Kevlar基布	180℃

Press Mouth Felt Pad Series



Available size

- width 30mm-1500mm
- Thickness 10mm 7+3, 6+4, 5+5, 4+6, 3+7
- Hard type According to the actual Situation, Choose Wheather It Needs To Be Treated With Resin
- Lengthch UP to 20000mm Treated with Resin

Type 型号	Color 颜色	Composition 组成	温度
PBO-100%	褐色Brown 褐色双面 Brown+Brown	纯PBO+PBO基布 (超高温双面出料口专用毡)	600℃
Pad-PKK	褐色加黄色 Brown+yellow	PBO+Kevlar基布 (普通单面机专用毡)	600℃
Pad-PK	褐色加黄色 Brown+yellow	PBO+Kevlar基布 (平板式PBO毡条)	600℃

Nomex Felt Strip

NN



Specifications:

- Standard size: 30-50mm length: 20000mm (20m/roll)
- Thickness: 6mm, 8mm, 10mm
- Working Temp: Consistent with the ageing oven process, fully meet the technical requirements
- Features: Improve the aluminum surface protection effectively, reduce the scratch caused by the iron rack ,profile transfer process.
- Mostly suitable for: The aluminium profiles with the high quality surface requirement avoid the loss in second operation's and transit bumps or rub when order is in production.



**Iron rack without felt protection
(unprotected)**

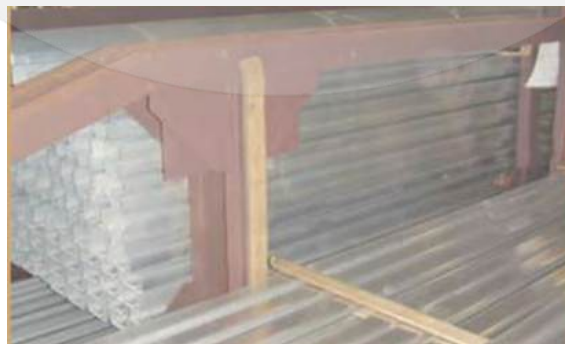

Iron rack with felt protection

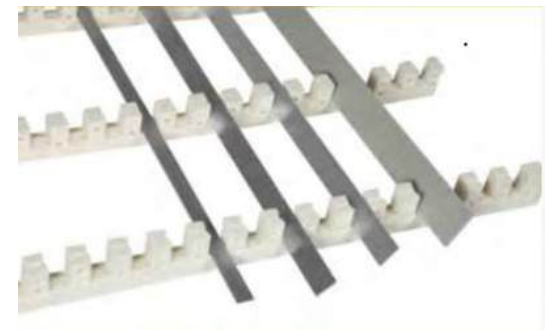

Nomex Felt For Special Profile

Spacer Sleeve

Please kindly provide us the aluminium spacer size: length*width*height, according to your requirement, we can produce various specification spacing material, spacer sleeve for the aging furnace.



Specifications:

- Nomex spacer sleeve for aging furnace
- Type N-S, Color Off white composition 100% nomex Temp. up to 220-280°C
- Type PE-S Color White/Red/Green/Black Composition 100% polyester Temp. up to 150-180°C
- Thickness 1.3,1.6,1.8,2.0, 3.0 (230 g/m —1000 g/m)

Timing Belt Series

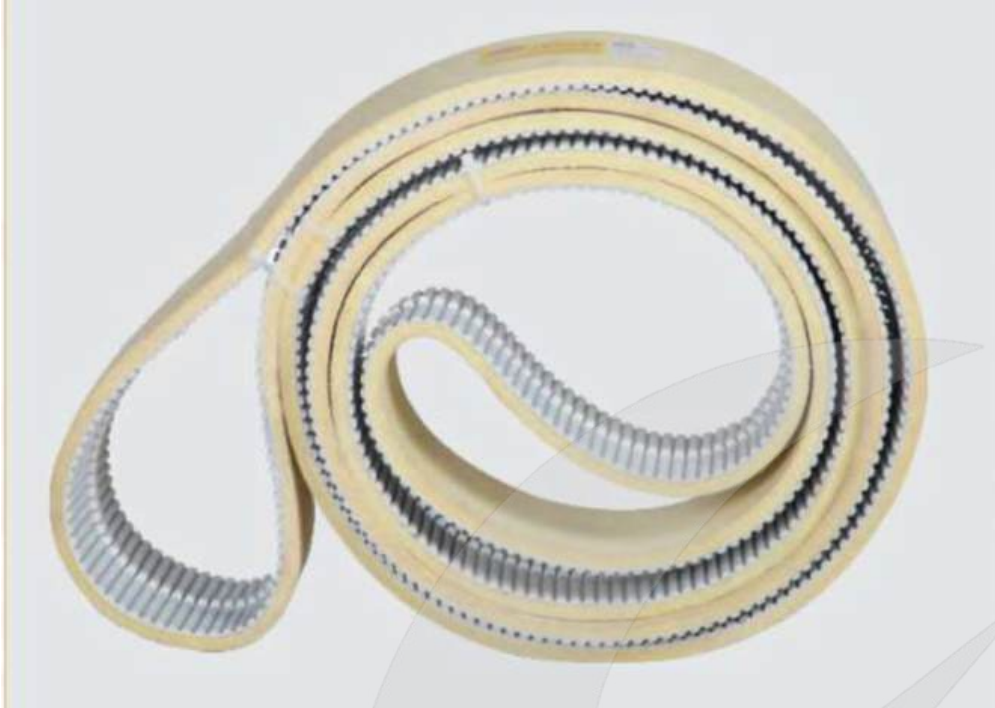

Specifications:

- Select PVC bonding or felt bonding for room temp. Conveyor
- Timing Belt T20.ATK10.HTD14M
- PVC seamless steel structure timing belt
 1. Bonding type with felts PE
- PE seamless steel structure timing belt
 2. PE+PE bonding type



Galvanized Steel Roller

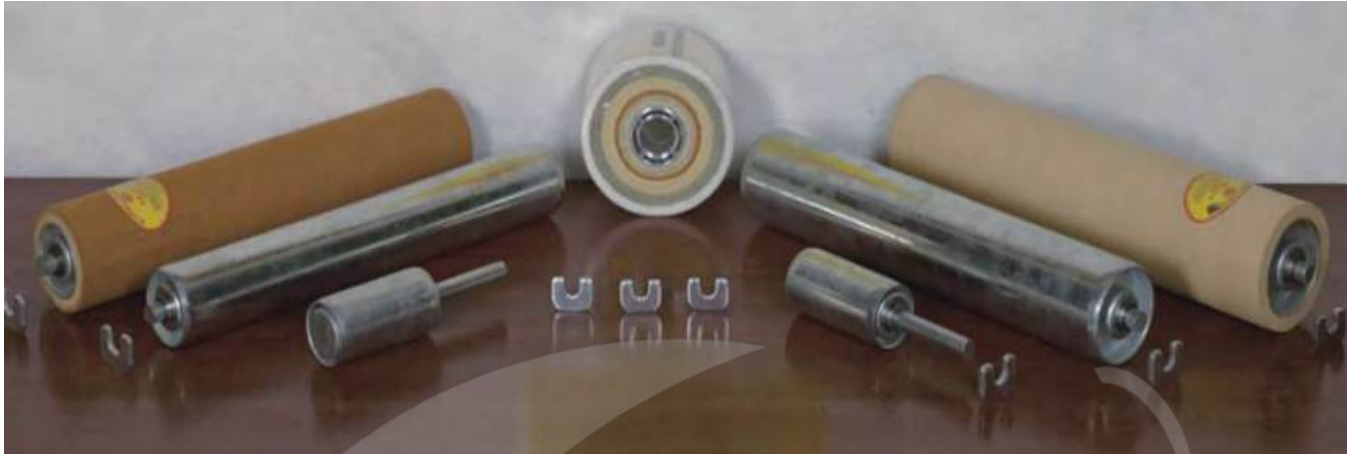

Specifications:

- Side Roller: $\phi 15 \times \phi 50 \times 100 \times 180$

- Finished products Conveyor Roller:

1. $\phi 15 \times \phi 50 \times 450 \times 480$
2. $\phi 15 \times \phi 60 \times 450 \times 48$

- Initial table conveyor roller (high Temp):

1. $\phi 15 \times \phi 60 \times 400 \times 430$
2. $\phi 15 \times \phi 76 \times 400 \times 430$

- 15# Mitrix supports (to hang the rollers)

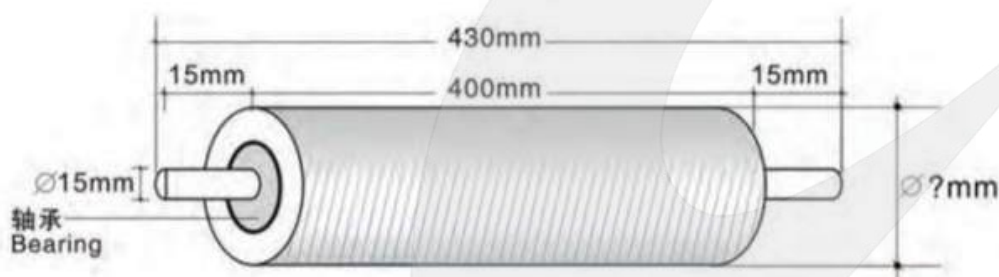

Galvanized Steel Roller

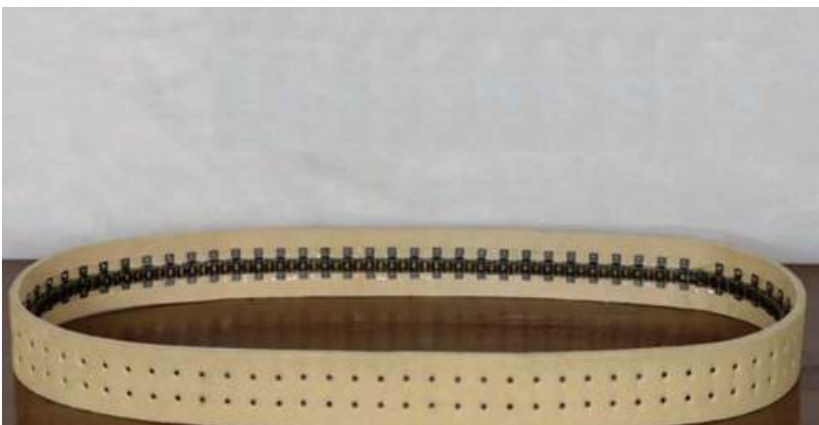

Specifications:

- Suitable for 2500T-10000T Press.
- Advantage: Strong pull, solving the convention al slip ping, achieve the effect of smooth delivery.
- According to customer specifications, felt surface effective range of 5mm.
- Technical parameter
 1. Teeth Space: 12.7mm, Minimum inner Arc: 300mm
 2. Teeth Space: 15.87mm, Minimum innerArc: 330mm
 3. Length: 11000mm
 4. Thickness: 10mm
 5. Width: 80mm-130mm
 6. Suitable Temp: 480°C 280°C

Slag Robot

Slag Robot Specification

1. Overview of the slag scraping robot scheme for aluminum alloy ingots According to the needs of customers, the following robot slag scraping scheme is made, which mainly consists of a set of slag scraping robot workstations. The robot synchronizes with the continuous casting machine through the synchronous tracker, and scrapes a thin layer of oxide skin on the surface of the aluminum alloy liquid that has just been cast, so that the cast aluminum alloy ingot has a bright surface without slag inclusions.



2. Introduction of the robot workstation for scraping slag of aluminum alloy ingots: For the slag scraping of aluminum alloy ingots, the slag scraping device is equipped on the slag scraping robot, and the slag scraping operation is performed by the tracking and positioning of the slag scraping robot. The slag scraping device is mainly composed of a handle and a shovel plate. The width of the end of the shovel plate is confirmed according to the actual width of the aluminum ingot, and the length of the handle is adjusted according to the situation within the effective stroke of the scraper robot



3. Slag scraping operation steps of aluminum alloy ingot The molten aluminum is cast to the ingot line through the diverter, and when it flows through the area where the slag scraping robot is located, the slag scraping robot performs the slag scraping operation.

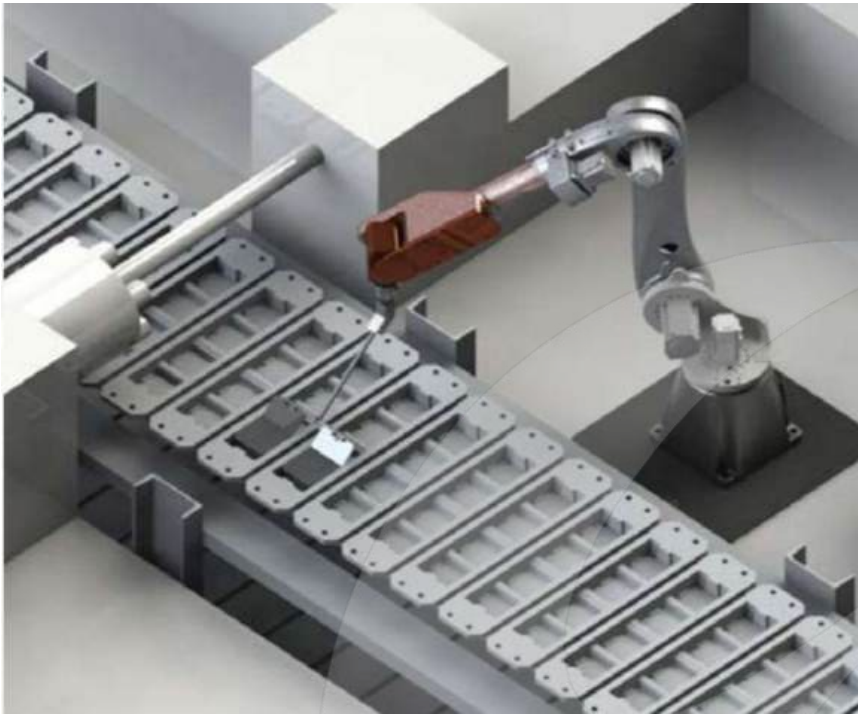

After the slag scraping operation in the previous step is completed, the slag scraping robot will shake off the solution residue in the scraper by means of inertia. The current scraping process is the scraping robot, as shown in the figure below

4. Technical parameter description and characteristics of aluminum alloy ingot slag scraping robot.

1	Scraper effective size	Depends on ingot size
2	Carrying weight	3kg
3	Robot maximum height	Working radius 1400mm
4	Robot rotation angle	360 degrees
5	Scraping speed	About 1 aluminum ingot/3s
6	The manipulator effectively lifts the weight	3Kg
7	Continuous working time	24h
8	Height from ground to mold level	Party A provides welding platform
9	Casting machine control mode	Inverter control

Model	MP-GP03
Movement radius mm	1400mm
control axis	6axis
End load weight	3kg
Repeatability	±0.30mm
Action range (°)	J1 : ±170 J2 : -75/+150 J3 : -165/+80 J4 : +360 J5 : +135 J6 : +360
Max speed (°/s)	J1 : 148.5 J2 : 148.5 J3 : 148.5 J4 : 509.5 J5 : 366.6 J6 : 594
Weight	75kg
Colour	Colour



Aluminum alloy ingot slag scraping robot engineering supporting facilities

No	Item	Detail
1	Detail	Mains power 380V 4-wire; The total power distribution of the equipment is about 2 kW; The main cable is connected to the connection point of the electric control cabinet of the seller's equipment; Plant lighting; Equipment installation power connection point
2	Supporting production equipment	All equipment other than contracted item
3	Party A cooperates with work and supplies of tools and facilities	Party B is responsible for the food and accommodation of the staff during the installation; Welding, cutting, electricity, lighting, temporary hoisting transportation tools, etc.;
4	Installation location	Indonesia



PT EXIMA MAJU PERKASA
FULFILLING YOUR NEEDS